

# TP SLOTTED STRUT CHANNELS

---

## ■ Application

- Light steel constructions
- Machines and technical facilities construction
- Suspended ceilings
- Mounting and installation
- Construction of ventilation and air duct systems, HVAC
- Sanitary systems
- Photovoltaic constructions
- Channel frame assembly
- Trapeze supports
- For electrical, telecommunication installations and piping.

## ■ Profile Length

Item Number	Channel	Length (Meter)
TP 12200	TP STC 27x18x1.2mm	2
TP 12201	TP STC 28X30X1.6mm	2
TP 12202	TP STC 41x21x2mm	2
TP 12203	TP STC 41x21x2mm	3
TP 12204	TP STC 41x21x2.5mm	3
TP 12205	TP STC 41x41x1.5mm	3
TP 12206	TP STC 41x41x2mm	2
TP 12207	TP STC 41x41x2mm	3
TP 12208	TP STC 41x41x2.5mm	3

## ■ Channels Dimensions

### ■ TP STC 27x18x1.2mm

Properties: Galvanized slotted strut channel

Pre-galvanized coating  $\geq 19\mu\text{m}$

Length = 2m

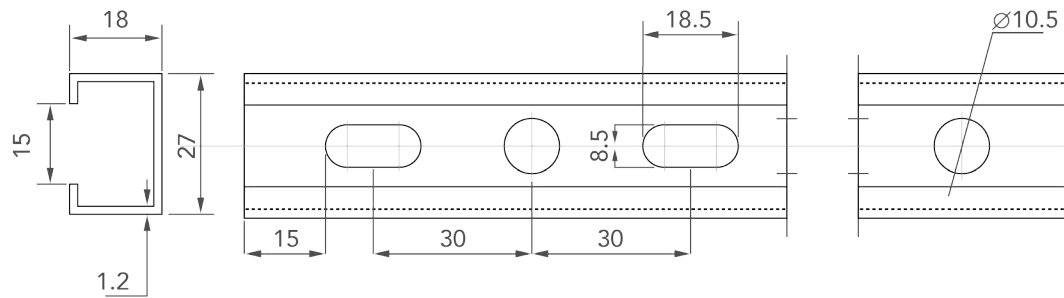

### ■ TP STC 28x30x1.6mm

Properties: Galvanized slotted strut channel

Pre-galvanized coating  $\geq 19\mu\text{m}$

Length = 2m

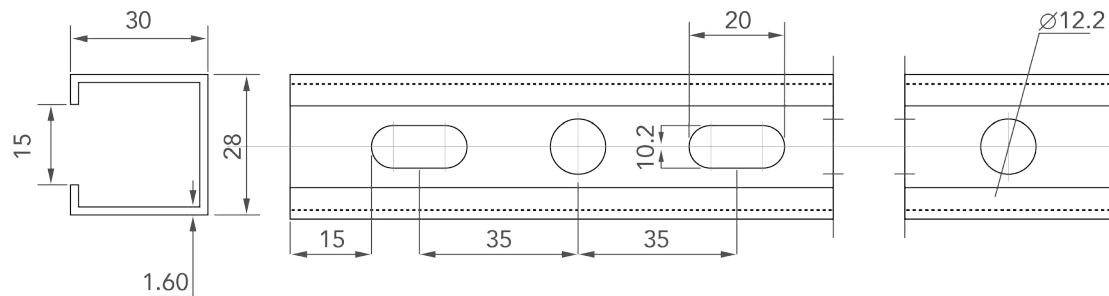

■ **TP STC 41x21x2mm**

Properties: Galvanized slotted strut channel

Pre-galvanized coating  $\geq 19\mu\text{m}$

Length = 2,3m

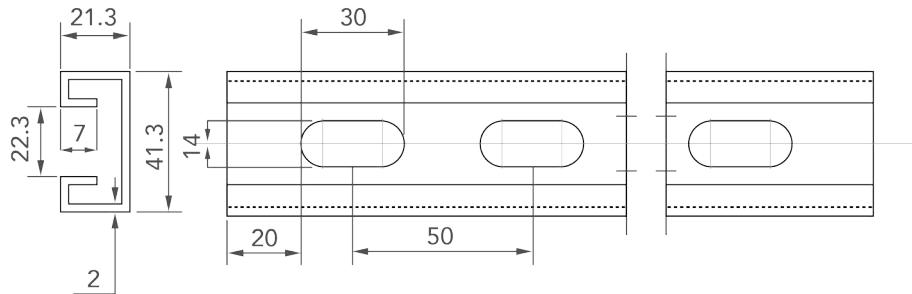

■ **TP STC 41x21x2.5mm**

Properties: Galvanized slotted strut channel

Pre-galvanized coating  $\geq 19\mu\text{m}$

Length = 3m

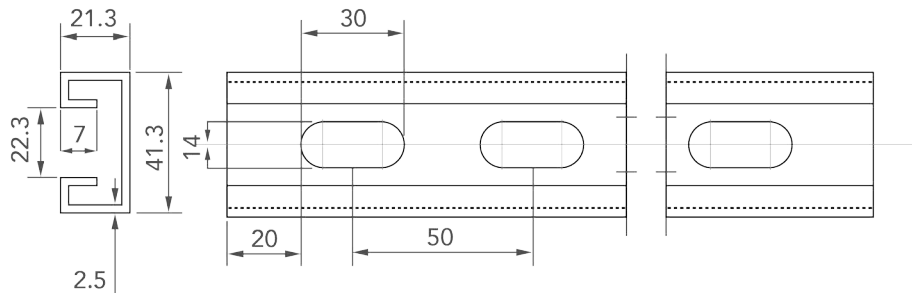

■ **TP STC 41x41x1.5mm**

Properties: Galvanized slotted strut channel

Pre-galvanized coating  $\geq 19\mu\text{m}$

Length = 3m

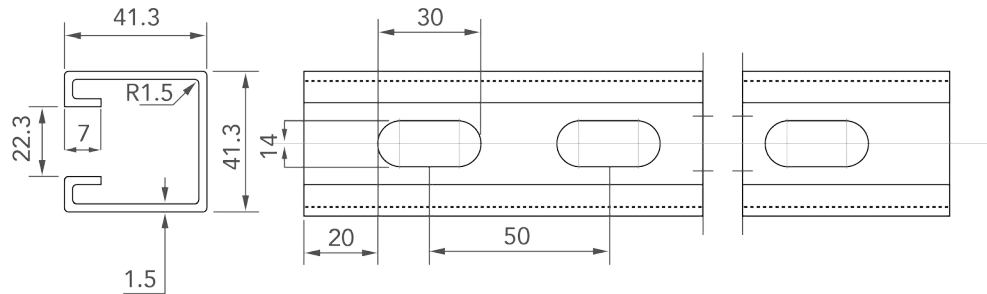

■ **TP STC 41x41x2mm**

Properties: Galvanized slotted strut channel

Pre-galvanized coating  $\geq 19\mu\text{m}$

Length = 2,3m

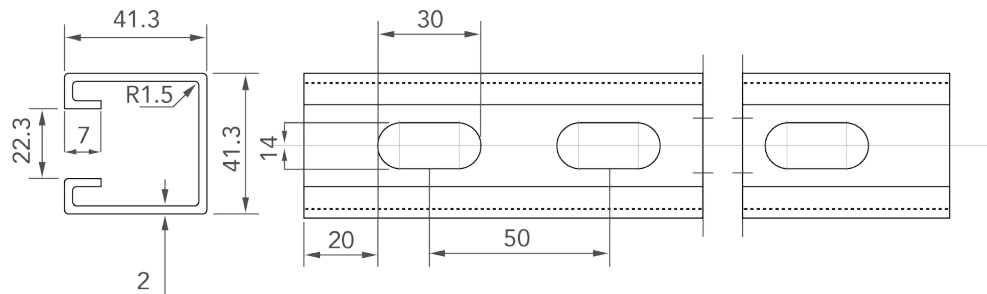

## ■ TP STC 41x41x2.5mm

Properties: Galvanized slotted strut channel

Pre-galvanized coating  $\geq 19\mu\text{m}$

Length = 3m

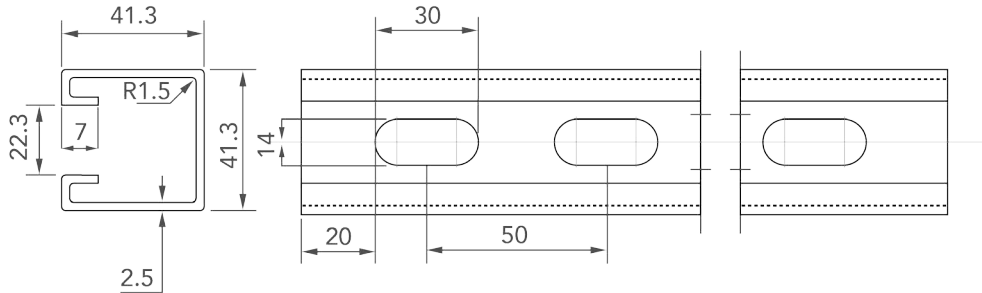

## ■ Characteristics

Dimension	Section [mm x mm]	Weight [Kg/m]	Area [cm <sup>2</sup> ]	Moment of inertia I <sub>y</sub> [cm <sup>4</sup> ]	Moment of inertia I <sub>z</sub> [cm <sup>4</sup> ]	Resistant module W <sub>y</sub> [cm <sup>3</sup> ]	Resistant module W <sub>z</sub> [cm <sup>3</sup> ]
TP STC 27x18x1.2mm	27 x 18	0.66	0.84	0.37	0.97	0.34	0.71
TP STC 28x30x1.6mm	28 x 30	1.25	1.60	1.79	2.10	1.03	1.50
TP STC 41x21x2mm	41 x 21	1.55	1.99	0.95	4.44	0.75	2.17
TP STC 41x21x2.5mm	41 x 21	1.71	2.28	1.32	5.54	1.03	2.70
TP STC 41x41x1.5mm	41 x 41	1.65	2.42	4.88	5.99	2.05	2.92
TP STC 41x41x2mm	41 x 41	2.09	2.65	5.84	7.62	2.46	3.72
TP STC 41x41x2.5mm	41 x 41	2.53	3.28	7.08	9.25	2.98	4.51